

# FLB468-II Backhoe Loader Specifications

# LOVOL

## FLB468-II Dimensions

Main Specifications		FLB468-II
Type		Side shift(H)
Transport dimensions (L×W×H)	mm	7350x2420x3500
Operating weight	kg	8600
Max. traction	kW	80
Max. speed	km/h	36
Electrical system	V	12
Bucket width	mm	2420
Backhoe bucket Width	mm	600
Min. turning radius		
Outside of front wheel	mm	6340
Wheel Tread		
Front Wheel	mm	1880
Rear Wheel	mm	1730
Loading specifications		
Max. dump height	mm	2690
Max. dump reach	mm	790
Total cycle time	s	≤9.6
Digging specifications		
Maximum bucket dig force	kN	38.5
Max. digging depth	mm	4340
Max. digging distance	mm	5370
Max. dump height	mm	3640
Minimum Ground Clearance	mm	5150
Steering system	Full Hydraulic Power Steering, adjustable Steering column.	
Bucket		
Front Loader Bucket	1.0m <sup>3</sup>	
Backhoe Loader Bucket	0.18m <sup>3</sup>	
Front Loader System has the Automatic bucket leveling		
Side shift of the backhoe for left and right	/	
Hydraulic system		
Flow rate	ml/r	(40+25+10)
Maximum hydraulic system	Mpa	21
Engine		
Model	/	Weichai WP4G95E221 engine
Type	/	Four cylinder inline, direct injection, water cooled
Max. torque	N·m	380

Transmission		
Brand	/	CARRARO
Model	/	TLB1
Transmission	/	Power shift ,four forward and four reverse
Driving axle		
Front axle	/	CARRARO
Rear axle	/	CARRARO
Front axle oscillation angle	11°	
Braking		
Service brake	Air boost braking system	
Wet drive axle,safe and reliable.		
Oil tank capacity		
Fuel tank	L	120
Hydraulic tank capacity	L	100
Tire		
Brand	ADVANCE	
Fuel tank	/	14-17.5-14PR
Rear tire	/	19.5L-24TL
Digging		
Optional 900mm extended arm		
Cab		
Sound proofing for assuring the noise inside the cabin	83dB	
Operator station	Hour Meter, Tachometer, Fuel level gauge, engine oil pressure alarm indicator, engine coolant temperature gauge, gearbox oil temperature gauge, charging indicator, Parking Brake, pressure alarm indication, overheating alarm of engine and gearbox.	
Backhoe operation Mechanism	Levers	
Front Loader Operation	Levers	



## LOVOL HEAVY INDUSTRY GROUP CO.,LTD.

Address: No. 75, Huanghe East Road, Huangdao District, Qingdao City, Shandong Province, China.  
 Website: en.wlovol.com      Alibaba: lovolconstruction.en.alibaba.com      Facebook: Cons Lovol  
 E-mail: lovol\_overseas@global.lovol.com      TEL: +86-532-86907190

As manufacturer, LOVOL has right to constantly upgrade and improve our products without informing to customers.  
 The pictures in literatures are for reference only, the detailed specifications are subject to real products.

Engine	<b>Weichai WP4G95E221 engine</b>
Rated Power	<b>70kw</b>
Loading Bucket Capacity	<b>1.0m<sup>3</sup></b>
Digging Bucket Capacity	<b>0.18m<sup>3</sup></b>
Operating Weight	<b>8600kg</b>

# FLB468-II

BACKHOE LOADER





## SAFE AND COMFORTABLE

- LOVOL exclusive full-mould produced cab, meets FOPS&ROPS standard.
- Full sealed streamlined cabin, beautiful and fashion, Silicone oil shock absorption reduce the noise of the cabin.
- The open field of 360 degree vision panoramic glass, 180 degree side window, pushing and pulling rear window, ensured the air flow in cabin.
- Air Suspension seat, adjustable between front and rear, can turn to 180 degree to ensure the different operation.
- Two instrumentations. Front and side instrument. Shows better view to the driver.
- Adjustable steering wheel can be adjusted according to the different height of driver.
- Service brake, vacuum booster, more safety.

## RELIABLE

- CARRARO gear box and axles, international well-known hydraulic parts, reliable quality.
- Chassis parts: Overall frame with box shape structure, the movement is smooth, with large carrying capacity.

- Wet brake. Friction plates are automatic adjusted, automatic wear compensation, safe and maintenance free ensured the braking system under excellent running for longer time.
- Double-wheel drive and four-wheel drive can be realized through the electronic control button, which ensure efficiency and safe driving.

## MULTI-FUNCTION

This backhoe loader can be with different kinds working device or tools.

- The loading side: can be equipped with normal bucket and multifunctional bucket, with function of loading, clamping, scraping, cutting, flat, fork etc.
- The digging side: can be equipped with normal bucket, milling machine, breaker, spiral drill, vibration compaction and other kinds of hydraulic attachments, with function of Mining, loading, pavement milling, cutting, crushing, land leveling etc.
- Extended long arm is optional.
- Side shift function: For H leg type, the digging device can be moved on the frame, to the right or left side for 1000mm, and can dig at side and enlarge the working area.

01

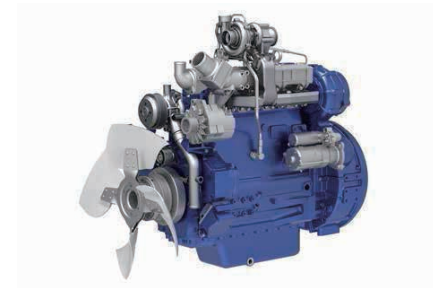

- Powerful Weichai WP4G95E221 engine.

02

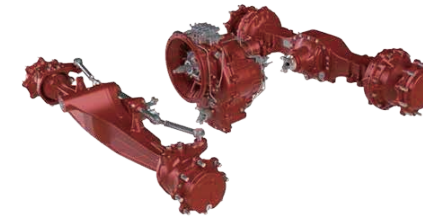

- Equipped with qualified original CARRARO transmission and axles from Italy. They feature synchronized shifting in all gears, and power shuttle between forward and reverse.

03



- Multi-valve for excellent performance. Full hydraulic load-sensing steering is advanced in technology and capability.

04



- 360°view cab with streamlined design offers an excellent visibility. With interior components shaped by injection mold, in-cab noise levels are the lowest in the business for maximum operator comfort.

05



- One-piece structure hood with DCPD material enhances the reliability

06

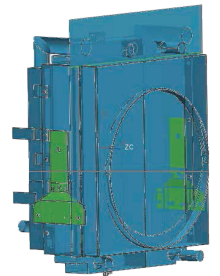

- A/C system is optimized with significantly improved cooling performance. With perfectly matched power, drivetrain and hydraulic systems, the radiation performance is improved.

07



- Water-proof plug connector improves reliability of electrics

08

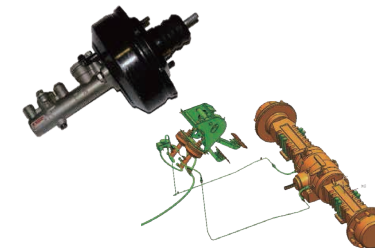

- All machines are fitted with servo assisted brakes as standard for low effort braking.

09

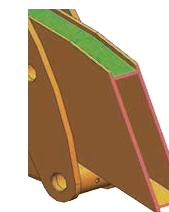

- Eight-bar mechanism is used for loading. Box-type lift arms ensure high reliability.

10

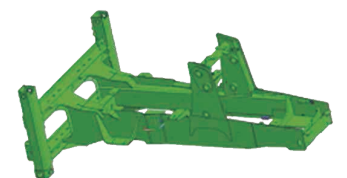

- H-type stand encloses the distance towards the wall for digging and adopted to more various working conditions